



## AL-S350/AL-S325

BASE IN ALLUMINIO | ALUMINIUM BASE | FUßKREUZ AUS ALUMINIUM

| DESCRIPTION                      | A (mm) | B (mm) | B' (mm) | C (mm) | D (mm) | E (mm) | N.W. (kg) | 20'container | Pallet |
|----------------------------------|--------|--------|---------|--------|--------|--------|-----------|--------------|--------|
| AL-S350                          | Ø 50   | 340    | 328,5   | Ø 11,2 | 142    | 23     | 2,4       | 1200 pcs     | 50 pcs |
| AL-S325                          | Ø 50   | 320    | 310     | Ø 11,2 | 135    | 26     | 1,7       | 1800 pcs     | 84 pcs |
| $\vartheta = 1^{\circ} 26' 16''$ |        |        |         |        |        |        |           |              |        |
| ANSI-BIFMA X5.1 - 2002/7         |        |        |         |        |        |        |           |              |        |

DATI TECNICI | TECHNICAL DATA | TECHNISCHE DATEN

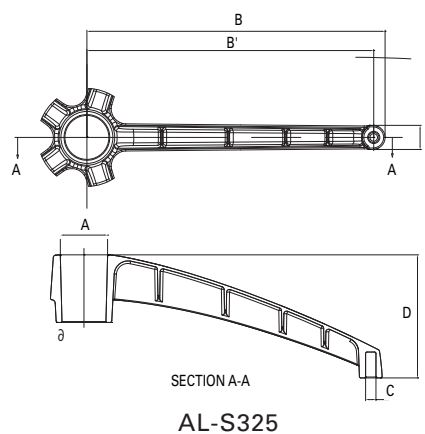
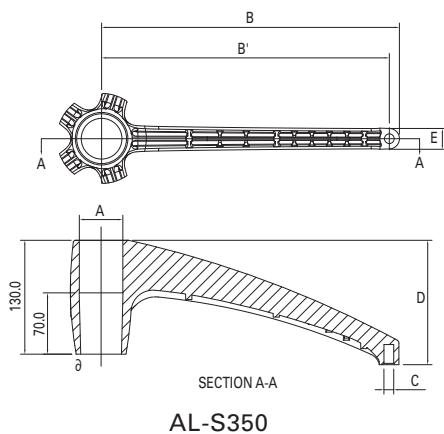

L&P OCI si riserva il diritto di apportare in qualsiasi momento, senza preavviso, modifiche alle caratteristiche tecniche dei propri modelli.

L&P OCI reserves the right to effect modifications, at any moment, without prior notification, to the technical characteristics of existing models.

L&P OCI behält sich das Recht vor, jederzeit und ohne vorherige Ankündigung technische Änderungen an allen Produkten vorzunehmen.